

## KITCHEN DRAWER DISH BASKET INSTALLATION INSTRUCTION (HINGE STYLE)

### 01 Name of each part

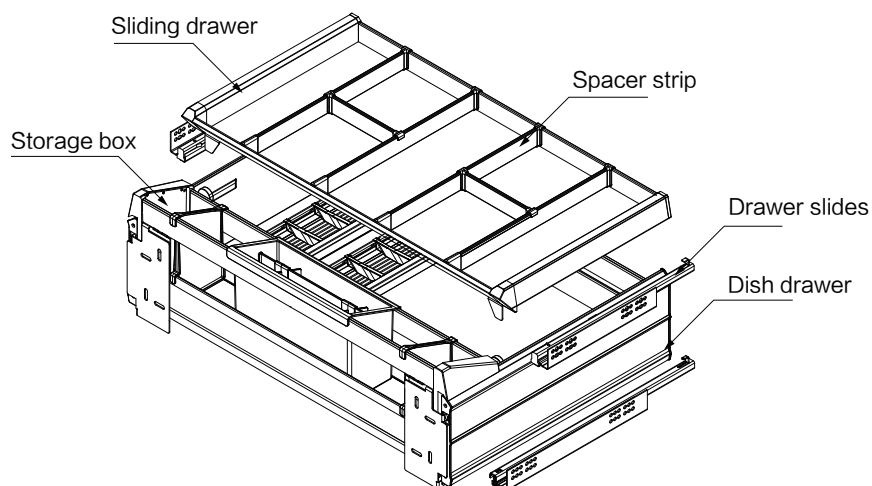

### 02 Product

Item No.	PO6284 ( 600 )	PO6284 ( 700 )	PO6284 ( 800 )	PO6284 ( 900 )
Product size	564 × 523 × 244	664 × 523 × 244	764 × 523 × 244	864 × 523 × 244
Carton size	690 × 556 × 300	790 × 556 × 300	890 × 556 × 300	990 × 556 × 300
Net weight	≈ 10.9	≈ 11.7	≈ 12.7	≈ 13.3
Gross weight	≈ 12.6	≈ 13.4	≈ 14.6	≈ 15.3
Metrial surface treatment		Metal parts: Aluminum/fluorocarbon spraying		Plastic parts: ABS
Implementation Standards GB/T 10125				

### 03 Cabinet Installation Requirements

1. Cabinet installation dimensions shall follow the diagram below (Default panel thickness: 18mm. For 16mm panels, install 2mm shims on both sides of the slide rails).

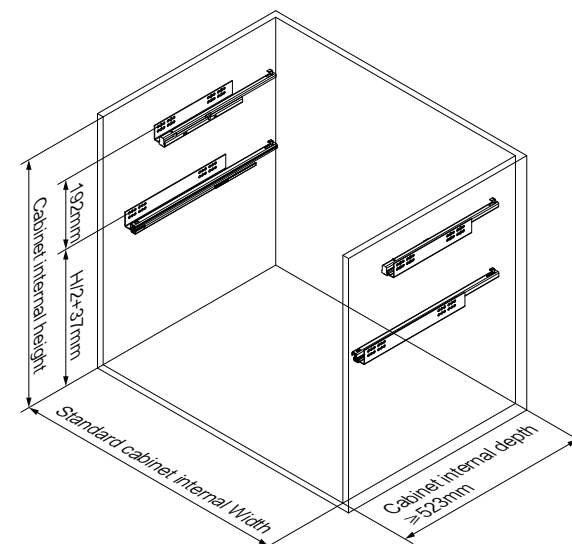
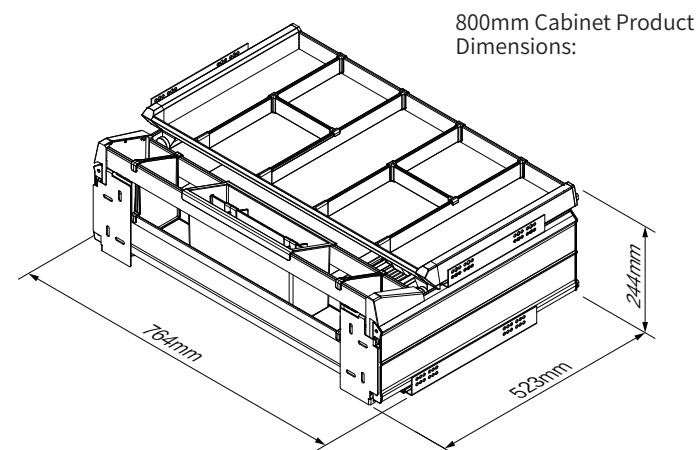

## 04 Product installation instruction

### 1 Installation of drawer slides:

1. Use the drawer slides installation template to drill holes according to the requirements shown in the diagram;
2. Flush against the cabinet side panel, then install the drawer slides.

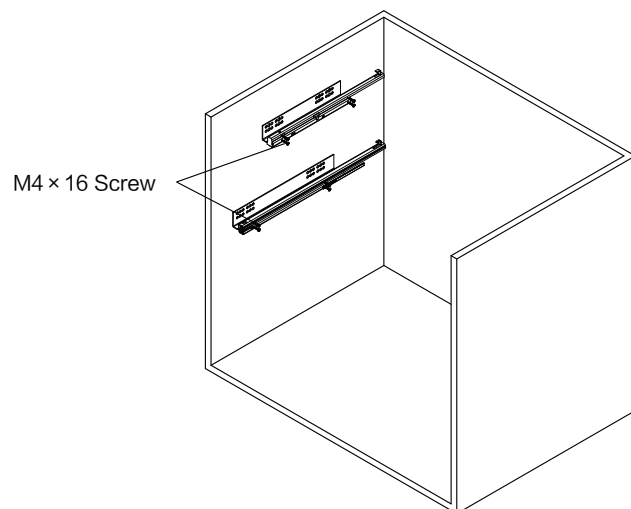
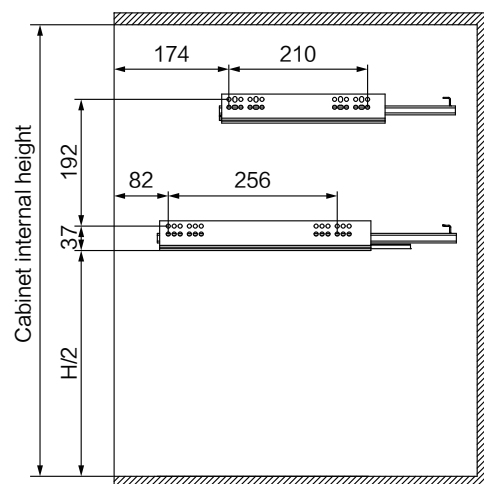

### 2 Installation of the basket:

1. According to the diagram, connect the slide rail hook to the rear end of the basket;
2. Push the upper slide drawer to the end, until the upper rail hooks engage the basket rear. From top to bottom, press the slide drawer to lock the rail.

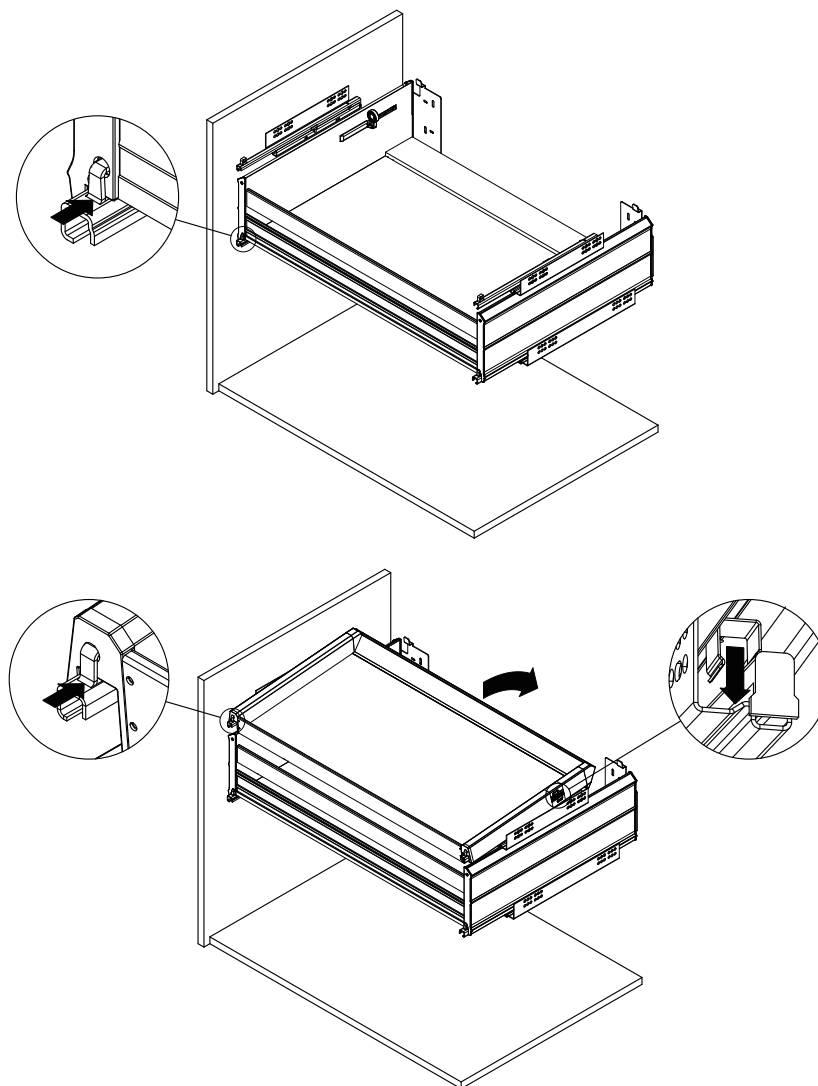

## 3 Door panel installation:

1. Use the door panel installation template to drill holes according to the requirements shown in the figure; (Default: Slide rail bottom and door panel bottom installed flush)
2. Use screws to fix the door panel.

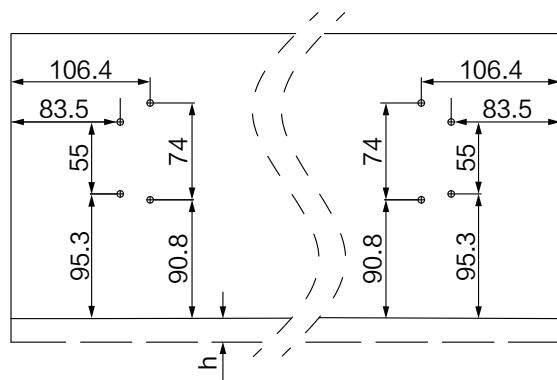

### Note:

1. By default, the bottom of the door panel is installed flush with the bottom of the slide rail, i.e.,  $h = 0$ .
2. If the door panel extends below the bottom of the slide rail, height  $h$  is added.

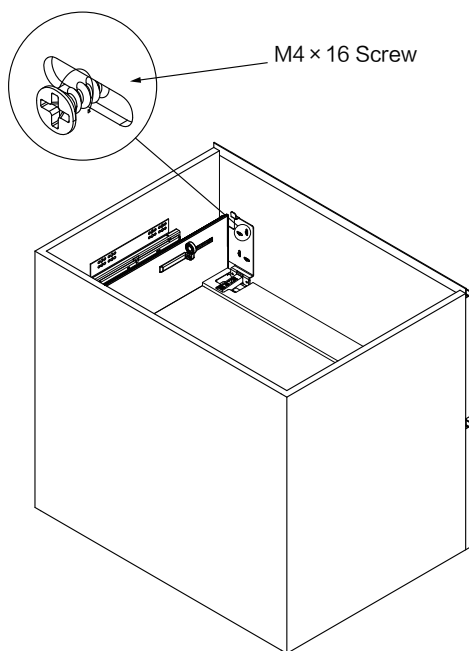

## 4 Door panel Adjustment:

1. Adjust the guide screw A to adjust the door panel forward and backward (clockwise, the door panel moves backward, counterclockwise, it moves forward);
2. Adjust the guide screw B to adjust the door panel up and down (clockwise, the door panel moves downward, counterclockwise, it moves upward);
3. After the door panel is adjusted, tighten the screws.

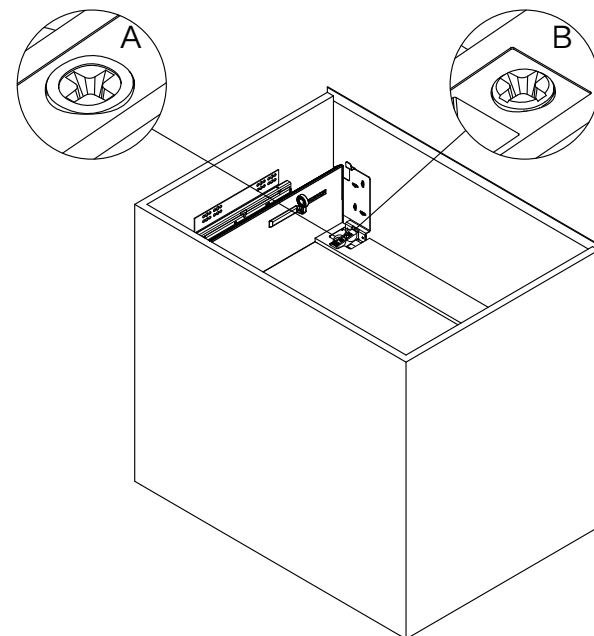

A

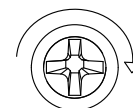

Backward

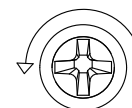

Forward

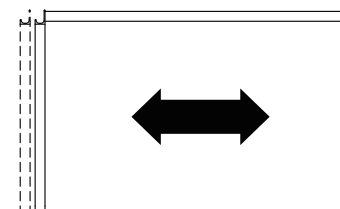

B



Downward



Upward

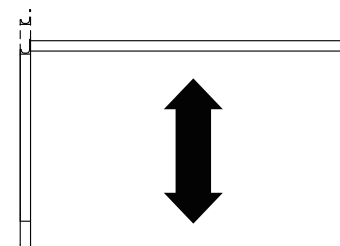

## 5 Storage box installation:

1. Hang the storage box along the door panel and onto the hook;
2. Install the door panel decorative cover.

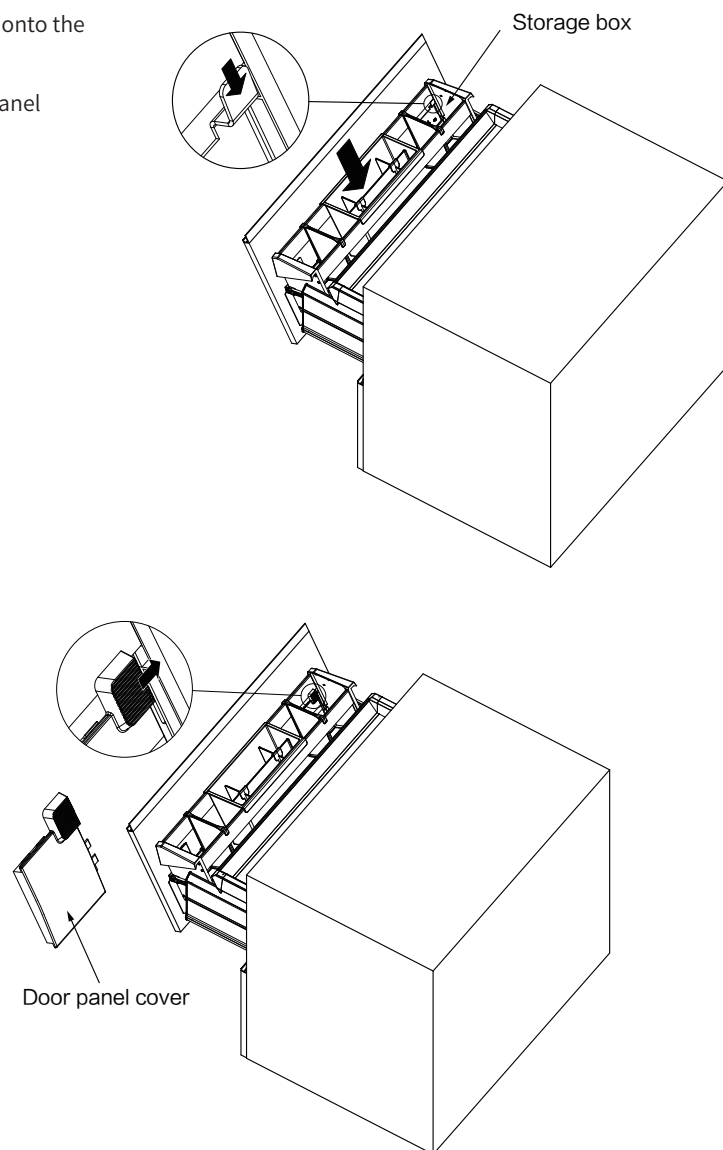

## 6 Product testing:

1. Test the smoothness of the guide rail and whether the door panel flips normally;
2. Installation is complete.

